

Selbstzentrierend

Für sehr hohe Drehmomente geeignet

Toleranzen: Durchmesser d h8

Toleranzen: Durchmesser dw

von 18 mm bis 30 mm H6/j6

von 30 mm bis 50 mm H6/h6

von 50 mm bis 80 mm H6/g6

von 80 mm bis 500 mm H7/g6

Oberflächenrauigkeit: R_a max 16 μ m

Kurze Einbauzeit

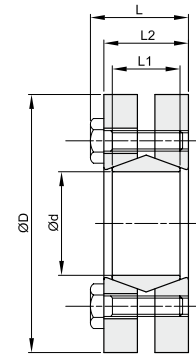
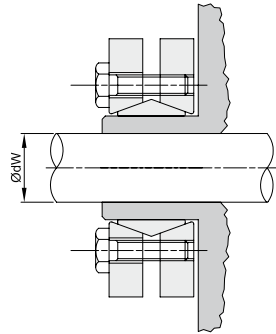

| d mm | dw mm | D mm | Artikelnr. | L1 mm | L2 mm | L mm | Flächen- | Über- | Axial- | Spannschrauben | | | kg |
|---------|----------|---------|-------------|----------|----------|---------|-------------------------------|------------------------------|-------------|----------------|-----------------|-------------------|-------|
| | | | | | | | pressung zwischen Welle | tragbares Dreh- moment | | kraft | DIN 931 10,9 | Anzugs- moment | |
| | | | | | | | pw N/mm ² | Mt Nm | F ax. KN | Nr. | Typ | Ms Nm | |
| 24 | 19 | 50 | BK019024050 | 14 | 19,5 | 23 | 272 | 162 | 15,0 | 6 | M5x18 | 4,9 | 0,20 |
| | 200 | | | | | | | 18,5 | | | | | |
| | 238 | | | | | | | 21,0 | | | | | |
| 30 | 24 | 60 | BK019030060 | 16 | 21,5 | 25 | 221 | 285 | 15,7 | 7 | M5x18 | 4,9 | 0,30 |
| | 323 | | | | | | | 23,7 | | | | | |
| | 361 | | | | | | | 26,7 | | | | | |
| 36 | 28 | 72 | BK019036072 | 18 | 23,5 | 27,5 | 292 | 418 | 27,0 | 5 | M6x20 | 11,8 | 0,40 |
| | 542 | | | | | | | 38,0 | | | | | |
| | 599 | | | | | | | 43,0 | | | | | |
| 44 | 32 | 80 | BK019044080 | 20 | 25,5 | 29,5 | 301 | 589 | 44,0 | 7 | M6x20 | 11,8 | 0,60 |
| | 741 | | | | | | | 49,0 | | | | | |
| | 817 | | | | | | | 54,0 | | | | | |
| 50 | 38 | 90 | BK019050090 | 22 | 27,5 | 31,5 | 275 | 893 | 48,8 | 8 | M6x25 | 11,8 | 0,80 |
| | 1102 | | | | | | | 58,8 | | | | | |
| | 1311 | | | | | | | 69,0 | | | | | |
| 55 | 42 | 100 | BK019055100 | 23 | 30,5 | 34,5 | 239 | 1102 | 48,0 | 8 | M6x25 | 11,8 | 1,10 |
| | 1444 | | | | | | | 61,7 | | | | | |
| | 1786 | | | | | | | 77,0 | | | | | |
| 62 | 48 | 110 | BK019062110 | 23 | 30,5 | 34,5 | 265 | 1758 | 69,0 | 10 | M6x25 | 11,8 | 1,30 |
| | 2090 | | | | | | | 80,9 | | | | | |
| | 2280 | | | | | | | 90,0 | | | | | |
| 68 | 50 | 115 | BK019068115 | 23 | 30,5 | 34,5 | 242 | 1900 | 71,2 | 10 | M6x25 | 11,8 | 1,40 |
| | 2375 | | | | | | | 80,9 | | | | | |
| | 2993 | | | | | | | 95,7 | | | | | |
| 75 | 55 | 138 | BK019075138 | 25 | 32,5 | 37,8 | 259 | 2375 | 94,4 | 7 | M8x30 | 29,4 | 1,70 |
| | 3040 | | | | | | | 111,0 | | | | | |
| | 3753 | | | | | | | 126,0 | | | | | |
| 80 | 60 | 145 | BK019080145 | 25 | 32,5 | 37,8 | 243 | 3040 | 99,3 | 7 | M8x30 | 29,4 | 1,90 |
| | 7505 | | | | | | | 115,0 | | | | | |
| | 4370 | | | | | | | 130,0 | | | | | |
| 90 | 65 | 155 | BK019090155 | 30 | 39 | 44,3 | 257 | 4513 | 141,0 | 10 | M8x35 | 29,4 | 3,30 |
| | 5700 | | | | | | | 160,0 | | | | | |
| | 6888 | | | | | | | 178,0 | | | | | |
| 100 | 70 | 170 | BK019100170 | 34 | 44 | 49,3 | 245 | 6555 | 163,0 | 12 | M8x35 | 29,4 | 4,70 |
| | 7125 | | | | | | | 182,0 | | | | | |
| | 8550 | | | | | | | 202,0 | | | | | |
| 110 | 75 | 185 | BK019110185 | 39 | 50 | 56,4 | 232 | 6840 | 185,0 | 9 | M10x40 | 57,8 | 5,90 |
| | 8550 | | | | | | | 207,0 | | | | | |
| | 10260 | | | | | | | 221,0 | | | | | |
| 125 | 85 | 215 | BK019125215 | 42 | 54 | 60,4 | 253 | 10450 | 240,0 | 12 | M10x40 | 57,8 | 8,30 |
| | 12350 | | | | | | | 262,0 | | | | | |
| | 14250 | | | | | | | 285,0 | | | | | |
| 140 | 95 | 230 | BK019140230 | 46 | 60,5 | 68 | 251 | 14345 | 308,0 | 10 | M12x45 | 98 | 10,00 |
| | 16720 | | | | | | | 331,0 | | | | | |
| | 19095 | | | | | | | 357,0 | | | | | |
| 155 | 105 | 265 | BK019155265 | 50 | 64,5 | 72 | 250 | 20900 | 366,0 | 12 | M12x50 | 98 | 15,00 |
| | 23750 | | | | | | | 392,0 | | | | | |
| | 26600 | | | | | | | 417,0 | | | | | |
| 165 | 115 | 290 | BK019165290 | 56 | 71 | 81 | 263 | 29450 | 513,0 | 8 | M16x55 | 245 | 22,00 |
| | 33250 | | | | | | | 544,0 | | | | | |
| | 37050 | | | | | | | 564,0 | | | | | |
| 175 | 125 | 300 | BK019175300 | 56 | 71 | 81 | 248 | 34200 | 576,0 | 8 | M16x55 | 250 | 22,00 |
| | 38950 | | | | | | | 630,0 | | | | | |
| | 45000 | | | | | | | 666,0 | | | | | |