

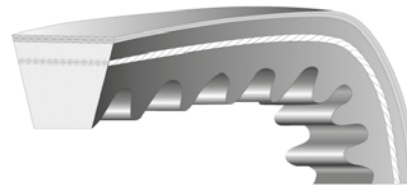

# KEILRIEMEN CONTI® V „FO“ – FLANKENOFFENE SCHMALKEILRIEMEN

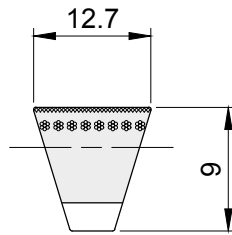

## XPA

## XPA

Beschreibung	Artikelnr.	Richtlänge Ld mm	kg
XPA 732	CVFOXPA0732	732	0,091
XPA 757	CVFOXPA0757	757	0,094
XPA 782	CVFOXPA0782	782	0,097
XPA 800	CVFOXPA0800	800	0,100
*XPA 807	CVFOXPA0807	807	0,101
XPA 820	CVFOXPA0820	820	0,102
XPA 832	CVFOXPA0832	832	0,104
XPA 850	CVFOXPA0850	850	0,106
XPA 857	CVFOXPA0857	857	0,107
XPA 882	CVFOXPA0882	882	0,110
XPA 900	CVFOXPA0900	900	0,112
XPA 907	CVFOXPA0907	907	0,113
XPA 925	CVFOXPA0925	925	0,115
XPA 932	CVFOXPA0932	932	0,116
XPA 950	CVFOXPA0950	950	0,118
XPA 957	CVFOXPA0957	957	0,119
XPA 967	CVFOXPA0967	967	0,120
XPA 982	CVFOXPA0982	982	0,122
XPA 1000	CVFOXPA1000	1000	0,124
XPA 1007	CVFOXPA1007	1007	0,125
XPA 1032	CVFOXPA1032	1032	0,128
XPA 1060	CVFOXPA1060	1060	0,132
XPA 1082	CVFOXPA1082	1082	0,135
XPA 1107	CVFOXPA1107	1107	0,138
XPA 1120	CVFOXPA1120	1120	0,139
XPA 1132	CVFOXPA1132	1132	0,141
XPA 1150	CVFOXPA1150	1150	0,143
XPA 1157	CVFOXPA1157	1157	0,144
XPA 1180	CVFOXPA1180	1180	0,147
XPA 1200	CVFOXPA1200	1200	0,149
XPA 1207	CVFOXPA1207	1207	0,150
XPA 1232	CVFOXPA1232	1232	0,153
XPA 1250	CVFOXPA1250	1250	0,155
XPA 1257	CVFOXPA1257	1257	0,156
XPA 1272	CVFOXPA1272	1272	0,158
XPA 1282	CVFOXPA1282	1282	0,159
XPA 1307	CVFOXPA1307	1307	0,163
XPA 1320	CVFOXPA1320	1320	0,164
XPA 1332	CVFOXPA1332	1332	0,166
XPA 1357	CVFOXPA1357	1357	0,169
XPA 1382	CVFOXPA1382	1382	0,172
XPA 1400	CVFOXPA1400	1400	0,174
XPA 1432	CVFOXPA1432	1432	0,178
XPA 1450	CVFOXPA1450	1450	0,180
XPA 1457	CVFOXPA1457	1457	0,181
XPA 1482	CVFOXPA1482	1482	0,184
XPA 1500	CVFOXPA1500	1500	0,186
XPA 1507	CVFOXPA1507	1507	0,187
XPA 1532	CVFOXPA1532	1532	0,190

Beschreibung	Artikelnr.	Richtlänge Ld mm	kg
XPA 1550	CVFOXPA1550	1550	0,193
XPA 1557	CVFOXPA1557	1557	0,194
XPA 1582	CVFOXPA1582	1582	0,197
XPA 1600	CVFOXPA1600	1600	0,199
XPA 1607	CVFOXPA1607	1607	0,200
XPA 1632	CVFOXPA1632	1632	0,203
XPA 1650	CVFOXPA1650	1650	0,205
XPA 1657	CVFOXPA1657	1657	0,206
XPA 1682	CVFOXPA1682	1682	0,209
XPA 1700	CVFOXPA1700	1700	0,211
XPA 1732	CVFOXPA1732	1732	0,215
XPA 1750	CVFOXPA1750	1750	0,217
XPA 1757	CVFOXPA1757	1757	0,218
XPA 1800	CVFOXPA1800	1800	0,224
XPA 1832	CVFOXPA1832	1832	0,228
*XPA 1850	CVFOXPA1850	1850	0,230
XPA 1857	CVFOXPA1857	1857	0,231
XPA 1882	CVFOXPA1882	1882	0,234
XPA 1900	CVFOXPA1900	1900	0,236
XPA 1932	CVFOXPA1932	1932	0,240
XPA 1950	CVFOXPA1950	1950	0,242
XPA 1957	CVFOXPA1957	1957	0,243
XPA 2000	CVFOXPA2000	2000	0,248
XPA 2032	CVFOXPA2032	2032	0,252
XPA 2057	CVFOXPA2057	2057	0,256
XPA 2082	CVFOXPA2082	2082	0,259
XPA 2120	CVFOXPA2120	2120	0,263
XPA 2132	CVFOXPA2132	2132	0,265
XPA 2160	CVFOXPA2160	2160	0,268
XPA 2182	CVFOXPA2182	2182	0,271
XPA 2207	CVFOXPA2207	2207	0,274
XPA 2240	CVFOXPA2240	2240	0,278
XPA 2300	CVFOXPA2300	2300	0,286
XPA 2360	CVFOXPA2360	2360	0,293
XPA 2382	CVFOXPA2382	2382	0,296
XPA 2432	CVFOXPA2432	2432	0,302
XPA 2500	CVFOXPA2500	2500	0,310
XPA 2532	CVFOXPA2532	2532	0,314
XPA 2800	CVFOXPA2800	2800	0,348