

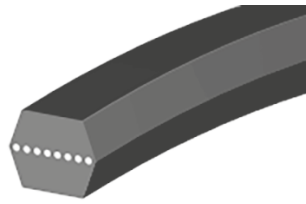

KEILRIEMEN CONTI[®] V „DUAL“ – KLASSISCH

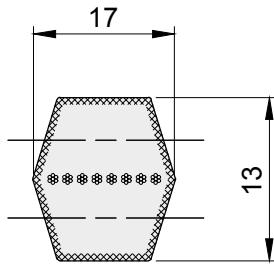

BB

Beschreibung	Artikelnr.	Länge Le mm	kg
*BB 74	CVDBB074	1908	0,459
BB 75	CVDBB075	1933	0,465
BB 76	CVDBB076	1958	0,471
BB 81	CVDBB081	2085	0,502
BB 83	CVDBB083	2136	0,514
BB 85	CVDBB085	2187	0,527
*BB 89	CVDBB089	2289	0,552
*BB 92	CVDBB092	2365	0,570
BB 94	CVDBB094	2416	0,583
BB 97	CVDBB097	2492	0,601
*BB 99	CVDBB099	2543	0,614
*BB 100	CVDBB100	2568	0,620
*BB 105	CVDBB105	2695	0,651
*BB 106	CVDBB106	2720	0,657
*BB 112	CVDBB112	2873	0,694
*BB 115	CVDBB115	2949	0,713
*BB 116	CVDBB116	2974	0,719
BB 117	CVDBB117	3000	0,725
*BB 118	CVDBB118	3025	0,731
BB 125	CVDBB125	3203	0,775
*BB 126	CVDBB126	126	0,781
*BB 127	CVDBB127	127	0,787
*BB 161	CVDBB161	161	0,998
BB 173	CVDBB173	173	1,072
BB 174	CVDBB174	174	0,494
*BB 181	CVDBB181	181	1,122
BB 216	CVDBB216	5514	1,326