



# ZAHNRIEMENRÄDER PROFIL HTD® FÜR TAPERBUCHSEN

## 14M

### Teilung 14 mm

für Zahnriemenbreite 55 mm

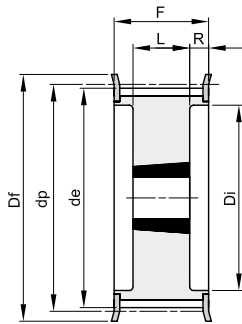

18F

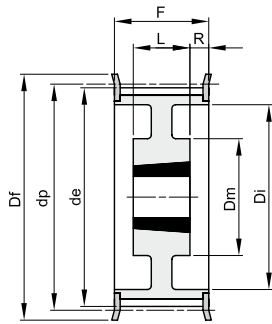

19F

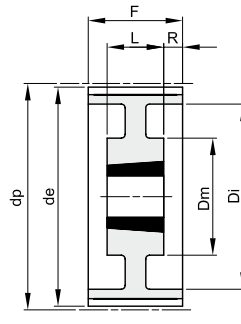

19

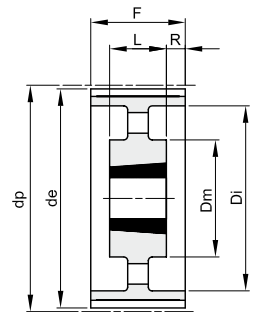

20

Werkstoff: Stahl

Werkstoff: Grauguss (GG)

code	Typ	Werkstoff	Zähne- zahl	Spann- buchsentyp	Bohrung max	dp	de	Df	Dm	Di	F	L	R	Nr. Bordscheiben	kg
TL 28 14M 55	18F	St	28	2012	50	124,78	122,12	127		94	70	32	19	400	2,20
TL 30 14M 55	18F	St	30	2517	60	133,69	130,99	138		100	70	45	12,5	401	2,70
TL 32 14M 55	18F	St	32	2517	60	142,60	139,88	154		108	70	45	12,5	403	3,60
TL 34 14M 55	18F	St	34	2517	60	151,52	148,79	160		110	70	45	12,5	404	4,50
TL 36 14M 55	18F	St	36	2517	60	160,43	157,68	168		120	70	45	12,5	405	5,20
TL 38 14M 55	18F	St	38	2517	60	169,34	166,60	183		130	70	45	12,5	406	6,20
TL 40 14M 55	18F	St	40	2517	60	178,25	175,49	188		138	70	45	12,5	407	6,90
TL 44 14M 55	18F	St	44	3020	75	196,08	193,28	211		155	70	51	9,5	411	8,60
TL 48 14M 55	18F	St	48	3020	75	213,90	211,11	226		170	70	51	9,5	412	10,50
TL 56 14M 55	18F	GG	56	3020	75	249,55	246,76	256		208	70	51	9,5	416	13,50
TL 64 14M 55	19F	GG	64	3020	75	285,21	282,41	296	170	240	70	51	9,5	418	14,50
TL 72 14M 55	19	GG	72	3020	75	320,86	318,06		170	280	70	51	9,5		16,30
TL 80 14M 55	20	GG	80	3020	75	356,51	353,71		170	315	70	51	9,5		17,50
TL 90 14M 55	20	GG	90	3020	75	401,07	398,28		170	360	70	51	9,5		20,00
TL112 14M 55	20	GG	112	3020	75	499,11	496,32		170	457	70	51	9,5		28,20
TL144 14M 55	20	GG	144	3020	75	641,71	638,92		170	600	70	51	9,5		36,00
TL168 14M 55	20	GG	168	3020	75	748,66	745,87		170	706	70	51	9,5		48,50
TL192 14M 55	20	GG	192	3020	75	855,62	852,82		170	813	70	51	9,5		52,00