



ZAHNRIEMENRÄDER PROFIL "AT"

METRIC PULLEYS "AT"

BAT 10

Teilung 10 mm
für Zahnriemenbreite 32 mm

Werkstoff: Aluminium UNI 9006 - T6 (Al)
geeignet zum Hartloxieren

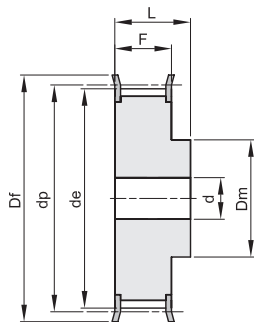

2F

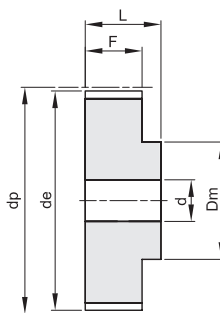

2

| code | Typ | Werkstoff | Zähne- zahl | de | Df | Dm | F | L | d | Nr. Bordscheiben | kg |
|--------------|-----|-----------|----------------|--------|-----|-----|----|----|----|---------------------|------|
| 47 BAT 10 18 | 2F | Al | 18 | 55,45 | 60 | 40 | 37 | 47 | 10 | 214 | 0,25 |
| 47 BAT 10 19 | 2F | Al | 19 | 58,65 | 66 | 44 | 37 | 47 | 10 | 216 | 0,29 |
| 47 BAT 10 20 | 2F | Al | 20 | 61,80 | 66 | 46 | 37 | 47 | 12 | 216 | 0,32 |
| 47 BAT 10 22 | 2F | Al | 22 | 68,20 | 75 | 52 | 37 | 47 | 12 | 218 | 0,39 |
| 47 BAT 10 24 | 2F | Al | 24 | 74,55 | 83 | 58 | 37 | 47 | 12 | 219 | 0,47 |
| 47 BAT 10 25 | 2F | Al | 25 | 77,75 | 83 | 60 | 37 | 47 | 12 | 219 | 0,53 |
| 47 BAT 10 26 | 2F | Al | 26 | 80,90 | 87 | 60 | 37 | 47 | 12 | 220 | 0,56 |
| 47 BAT 10 27 | 2F | Al | 27 | 84,05 | 91 | 60 | 37 | 47 | 12 | 221 | 0,60 |
| 47 BAT 10 28 | 2F | Al | 28 | 87,25 | 93 | 60 | 37 | 47 | 12 | 222 | 0,64 |
| 47 BAT 10 30 | 2F | Al | 30 | 93,65 | 97 | 60 | 37 | 47 | 12 | 223 | 0,74 |
| 47 BAT 10 32 | 2F | Al | 32 | 100,00 | 106 | 65 | 37 | 47 | 12 | 224 | 0,84 |
| 47 BAT 10 36 | 2F | Al | 36 | 112,75 | 119 | 70 | 37 | 47 | 16 | 225 | 1,06 |
| 47 BAT 10 40 | 2F | Al | 40 | 125,45 | 131 | 80 | 37 | 47 | 16 | 226 | 1,32 |
| 47 BAT 10 44 | 2 | Al | 44 | 138,20 | | 88 | 37 | 47 | 16 | | 1,61 |
| 47 BAT 10 48 | 2 | Al | 48 | 150,95 | | 95 | 37 | 47 | 16 | | 1,93 |
| 47 BAT 10 60 | 2 | Al | 60 | 189,15 | | 110 | 37 | 47 | 16 | | 3,00 |