

Teilung 75

Rollen Ø 31

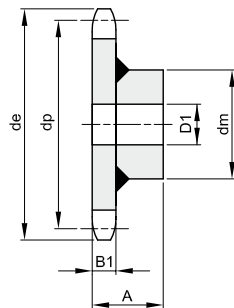
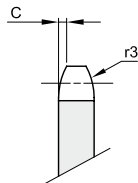

B1	C	r3
----	---	----

13,5	3	50
------	---	----

Werkstoff Stahl

Z	de	dp	dm	D1	A	kg
6	168,0	150,00	88	25	48,5	3,26
8	215,0	195,98	88	25	48,5	4,52
9	238,0	219,30	88	25	48,5	5,36
10	261,0	242,70	118	30	63,5	8,70
11	286,0	266,25	118	30	63,5	9,60
12	309,0	289,80	118	30	63,5	10,73

Z	de	dp	dm	D1	A	kg
13	333,0	313,42	118	30	63,5	11,83
14	357,0	337,05	118	30	63,5	13,15
15	380,0	360,73	118	30	63,5	14,45
16	404,0	384,45	133	30	65	17,43
20	499,0	479,40	133	30	65	23,80
21	523,0	503,17	133	30	65	26,07